

Technical Data

- through-hole or SMD
- 50mA/24VDC
- single pole/momentary
- 10.000.000 operations life time
- IP67 sealing
- temperature range:
high temp. switch; -40/+160°C
LED: -30/+85°C

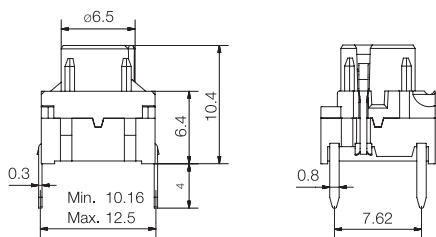

Dimensions (through-hole)



Top View

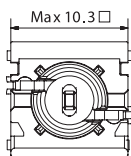

Dimensions (SMD)

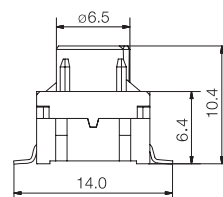

Top View

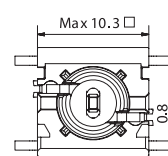

PCB layout and Circuit Diagram

1 LED

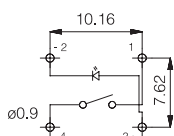

2 LEDS

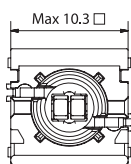
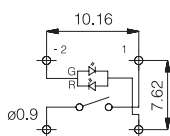

PCB layout and Circuit Diagram

1 LED

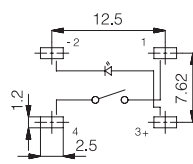

2 LEDS

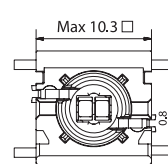
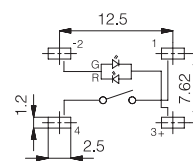

Technical specifications for 4F switch and LEDs see pages 35 and 36

How to order

4 F

Switch Mounting
SH9 surface mount
TH9 through-hole

LED Illuminated Cap

01
22
42
61
82
2242
8222
8242

Illuminated Cap

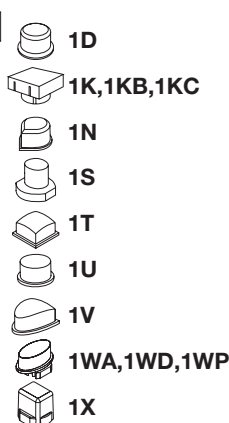

Colour code

11,16

11,16

10,12,14,16,18

11

16

16

16

16

11

Cap Solid Illuminated

Colour Lens

1E Solid Colour + lens 1,2,4,6,8

1F Solid Colour + lens 1,2,4,6,8

1Q Solid Colour + lens 1,6

1R Solid Colour + lens 1,6

Colour codes

LEDs
01 blue
22 green
42 yellow
61 white
82 red
2242 green/yellow
8222 red/green
8242 red/yellow

Illuminated Caps
10 frosted blue
11 transparent
12 frosted green
14 frosted yellow
16 frosted white
18 frosted red

Lenses
1 transparent
2 green
4 yellow
6 frosted white
8 red

Solid Colours

1E,1F 1Q,1R
00 blue 00 blue
02 green 03 grey
03 grey 08 red
04 yellow 09 black
06 white
08 red
09 black

Dimensions

Caps See Page
1D,1E,1F 15
1K,1KB,1KC 16
1N 14
1Q,1R 18
1S 21
1T,1U,1V 19
1WA,1WD,1WP 17
1X 20

Ordering example: 4FSH98242 + 1D11 or 4FTH922 + 1T16

For updates of products and/or changes of specifications please see www.mec.dk