

DETAILS

Product Number	CA15226_STRADA-SQ-FS3
Family	Strada
Type	Assembly
Color	clear
Diameter	25 + 25 mm
Height	16,2 mm
Style	square
Optic Material	PMMA
Holder Material	
Fastening	tape
Status	production ready
ROHS Compliant	Yes
Date Updated	15/12/2016



OPTICAL PROPERTIES

LED	Viewing Angle	Light Beam	Efficiency	cd/lm	Connector
PSL445	Asymmetric deg	Asymmetric	91 %	1.000	-
PSL440	Asymmetric deg	Asymmetric	91 %	1.900	-
MK-R	125 deg	Asymmetric	88 %	1.298	-
XM-L2	sim: Asym	Asymmetric	sim: 88 %	sim: 2.000	-
XT-E	sim: Asym	Asymmetric	sim: 87 %	sim: 2.500	-
Duris S10	Asymmetric deg	Asymmetric	86 %	1.100	-
Duris P10	sim: Asymmetric	Asymmetric	sim: 86 %	sim: 1.340	-

D C B A

4

4

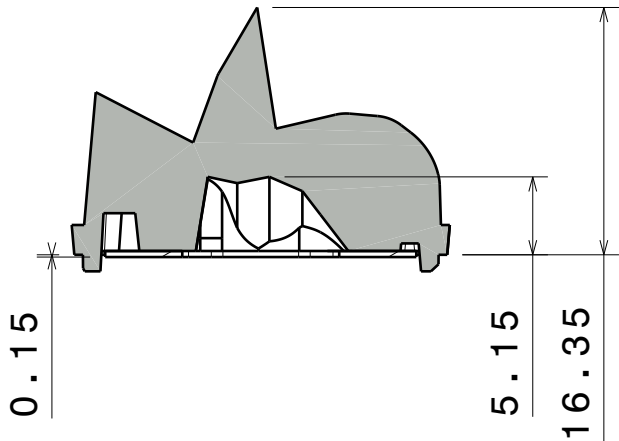

Section view A-A
Scale: 2:1

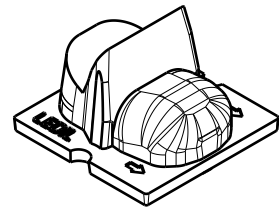

Isometric view
Scale: 1:1

3

3

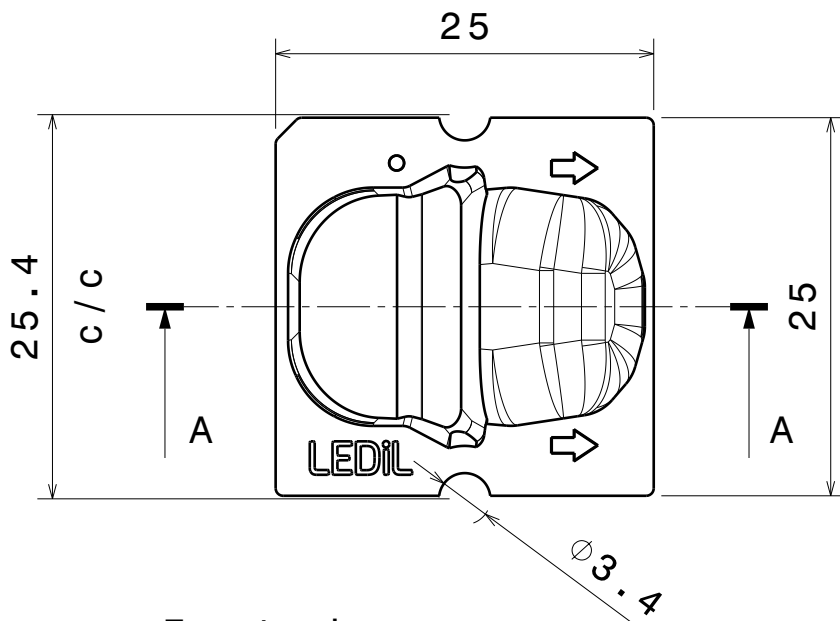

Front view
Scale: 2:1

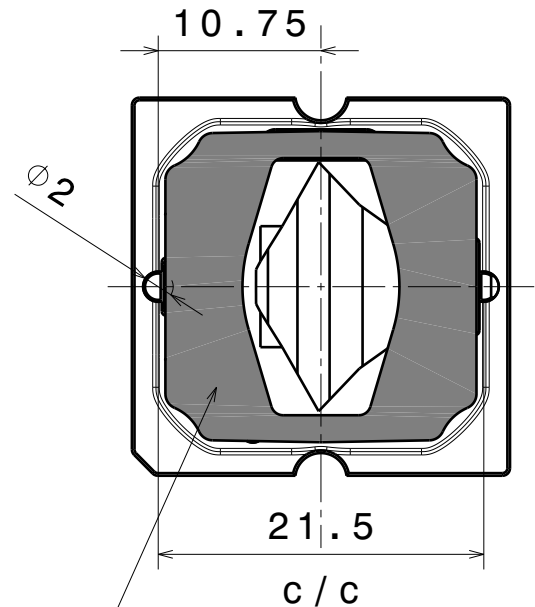

Rear view
Scale: 2:1

PU foam tape 0,4mm

2

2

INDEX	PART NO	DESCRIPTION	MATERIAL	COLOUR
1	C15109	STRADA-SQ-FS3	PMMA	

Tolerances if not otherwise shown
According to DIN ISO 2768-1
Linear measures:
Up to 30mm class M, otherwise class C.
According to DIN ISO 2768-2
Form and position: class L

LEDiL

Ledil Oy
Salorankatu 10
FIN 24240 SALO
Finland

THIRD ANGLE PROJECTION:

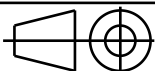

DRAWING TITLE

CA15226_STRADA-SQ-FS3

This drawing is the property
of LEDiL Oy. It may not be
reproduced, copied or
communicated without a written
agreement with LEDiL Oy.

SIZE PART NUMBER

A4

CA15226

SCALE 1:1 WEIGHT 3,51 g SHEET 1/1

1

1

D

A

Luminaire: LEDiL Oy CA15226_STRADA-SQ-FS3_(PSL445)

Lamps: 1 x Citizen_PSL445_424.116lm@250mA_P=2.81625W_I=0.250A_CCT=2700K

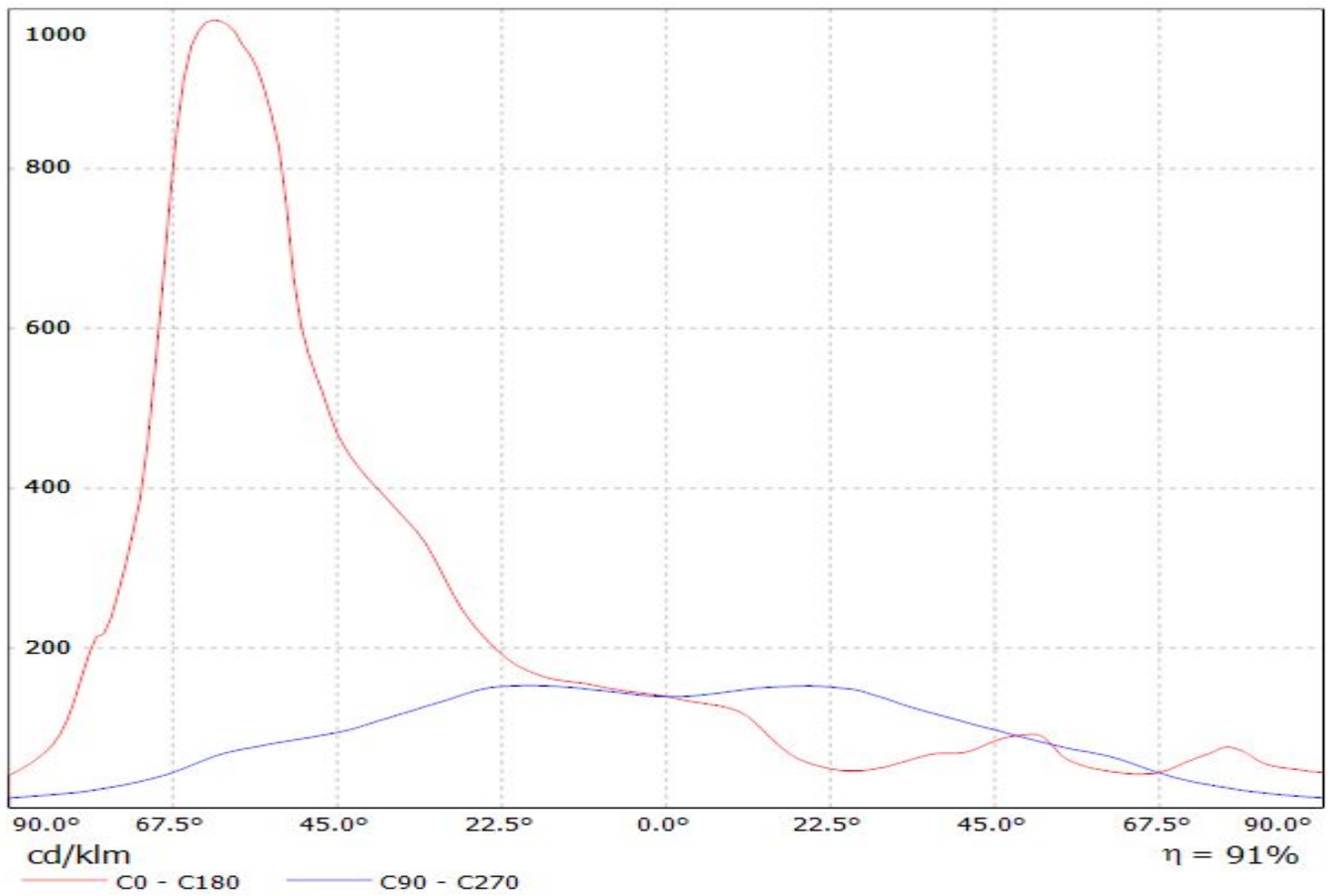

Luminaire: LEDiL Oy CA15226_STRADA-SQ-FS3_(PSL440)
Lamps: 1 x Citizen_PSL440_254.954lm@250mA_P=2.86296W_I=0.250A

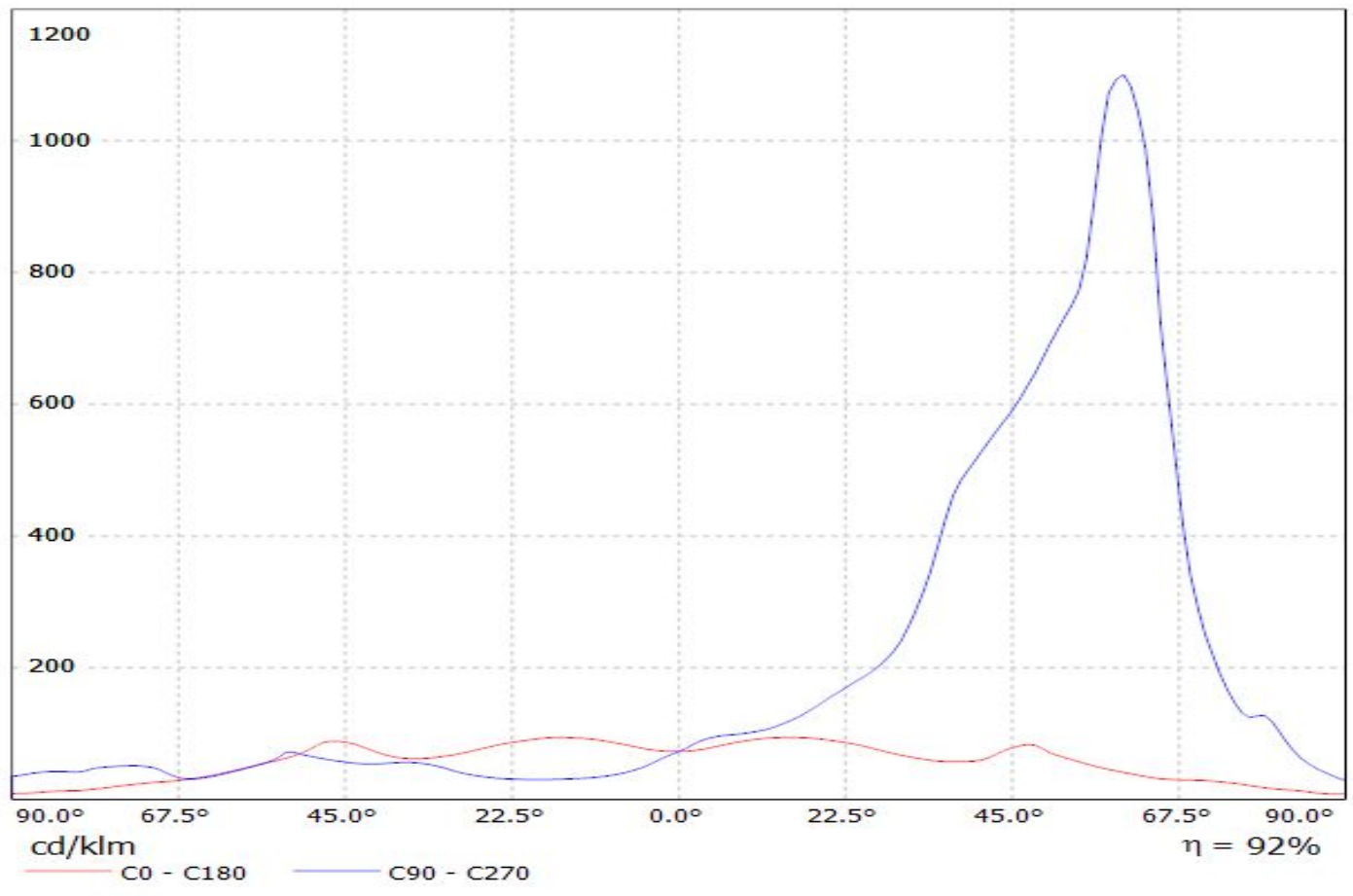

Luminaire: Ledil CA15226_STRADA-SQ-FS3_(MK-R)
Lamps: 1 x Cree_MK-R_(MKRAWT-0-30H-F2-D0-U-01)_300.489lm@250mA_P=2.8650W_I=0.250A

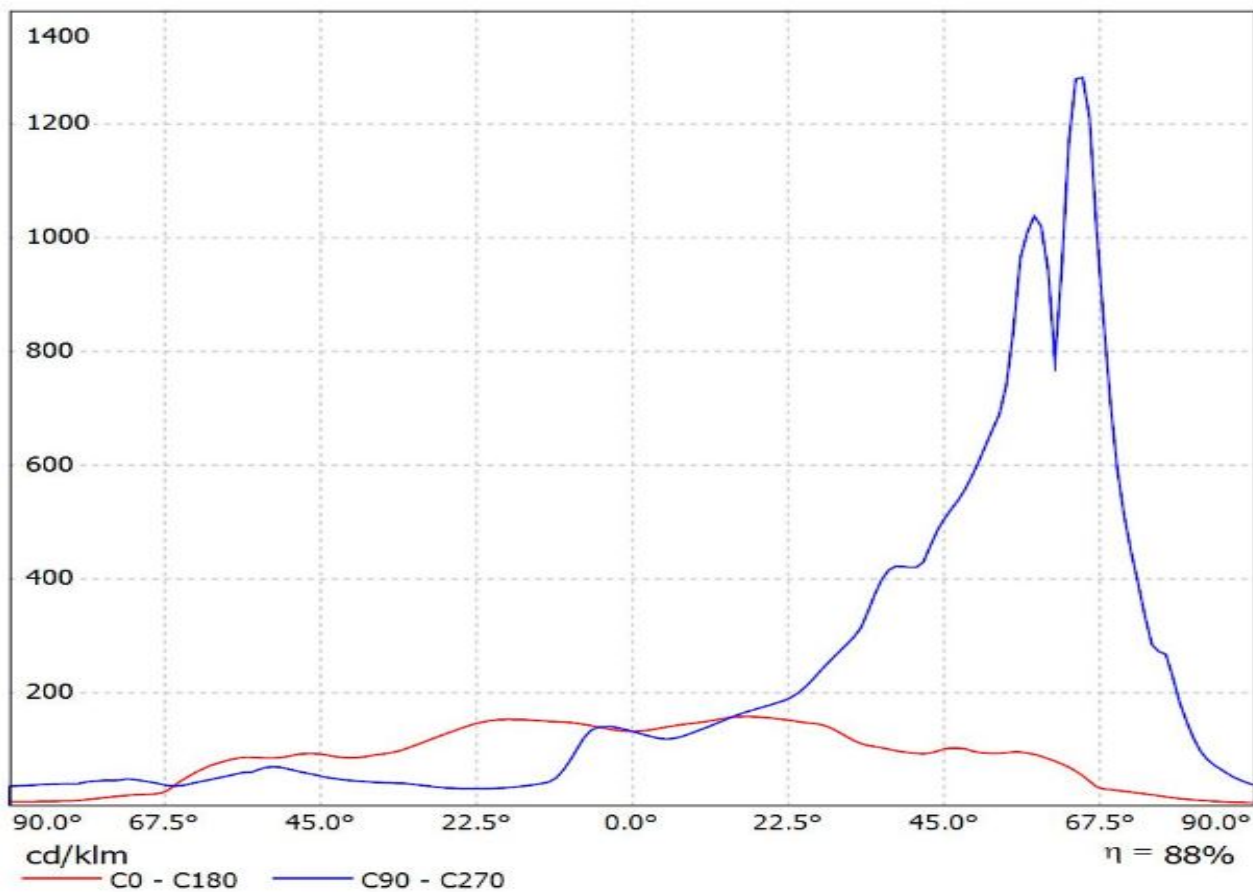

Luminaire: Ledil Oy CA15226_STRADA-SQ-FS3_(XM-L2)_SIMULATED
Lamps: 1 x Cree XM-L2

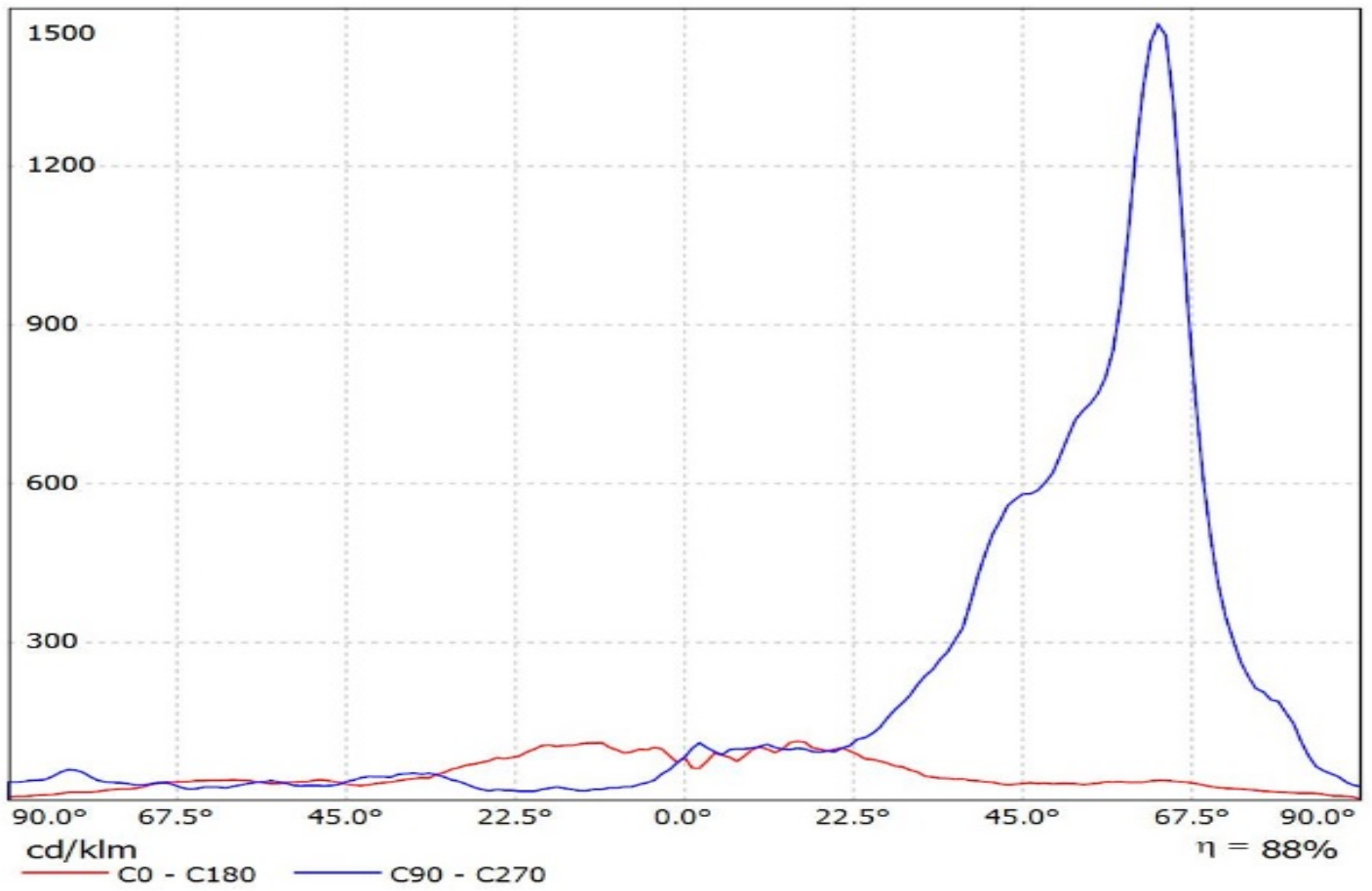

Luminaire: Ledil Oy CA15226_STRADA-SQ-FS3_(XT-E)_SIMULATED
Lamps: 1 x Cree XT-E

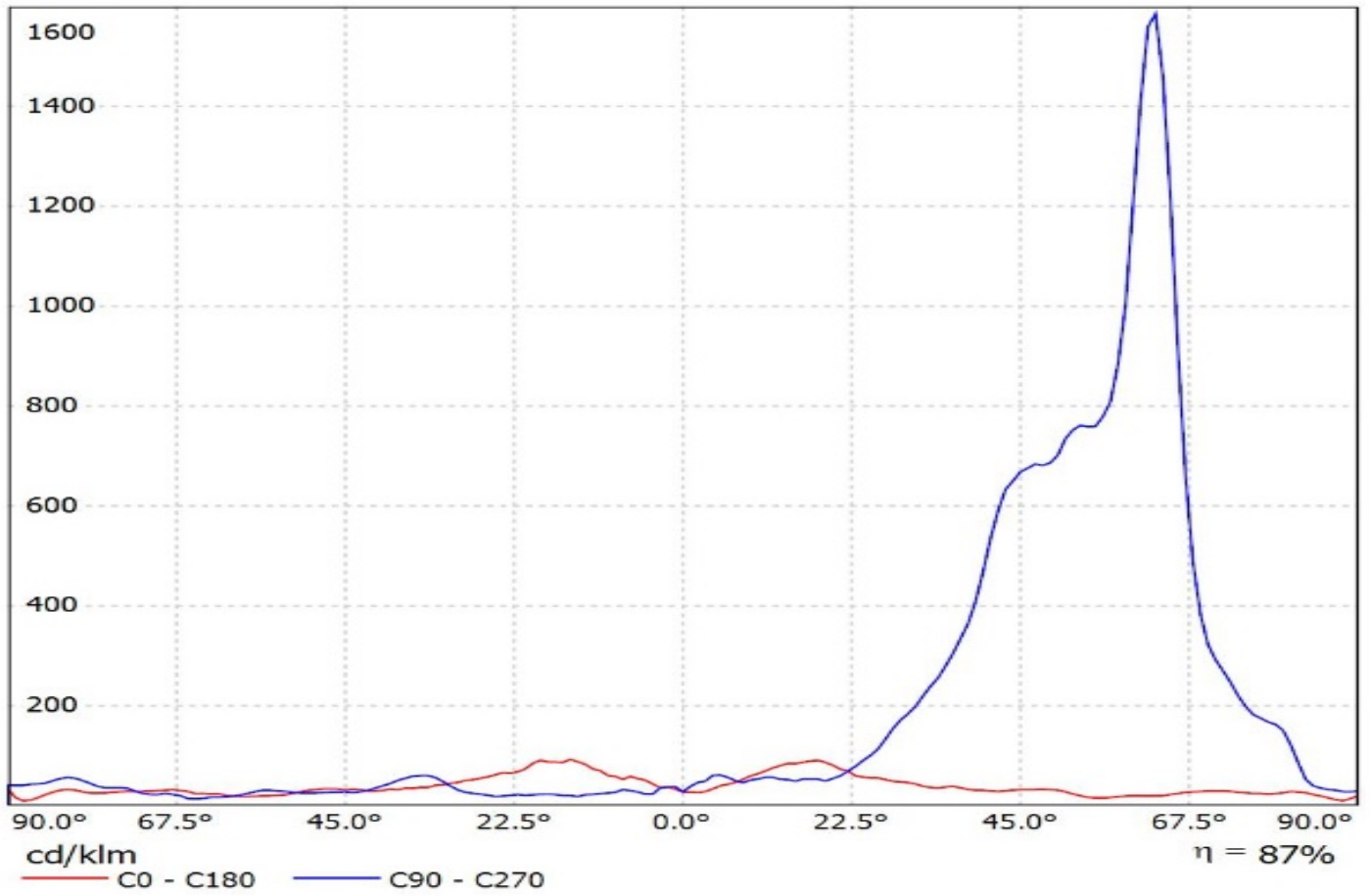

Luminaire: LEDiL Oy CA15226_STRADA-SQ-FS3_(DURIS_S10)
Lamps: 1 x Osram_Duris_S10_(GW-P7LP32-EM)_966.113lm@250mA_P=9.19689W_I=0.250A

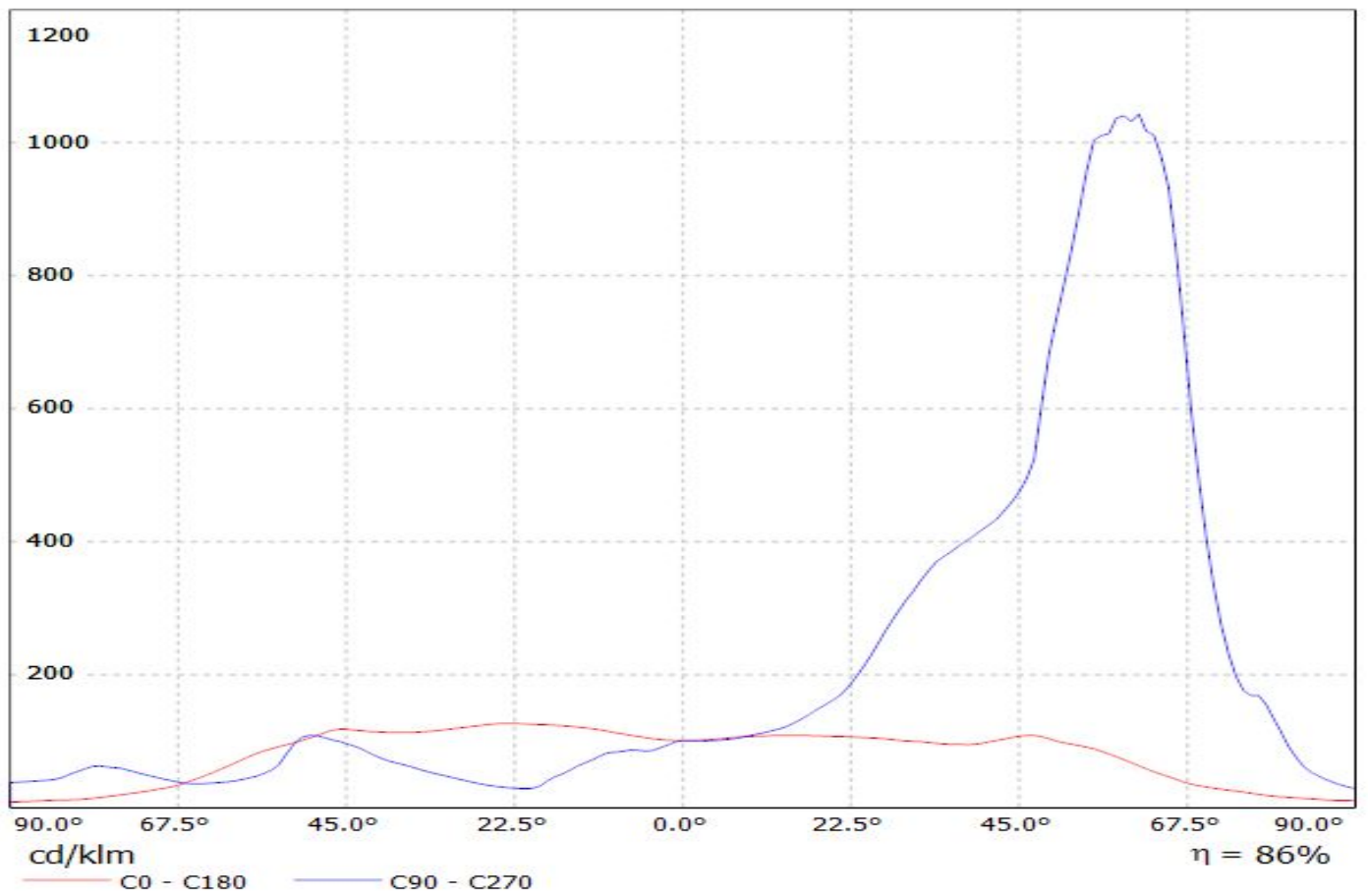

Luminaire: LEDiL Oy CA15226_STRADA-SQ-FS3 (PSL445)

Lamps: 1 x Citizen_PSL445_424.116lm@250mA_P=2.81625W_I=0.250A_CCT=2700K

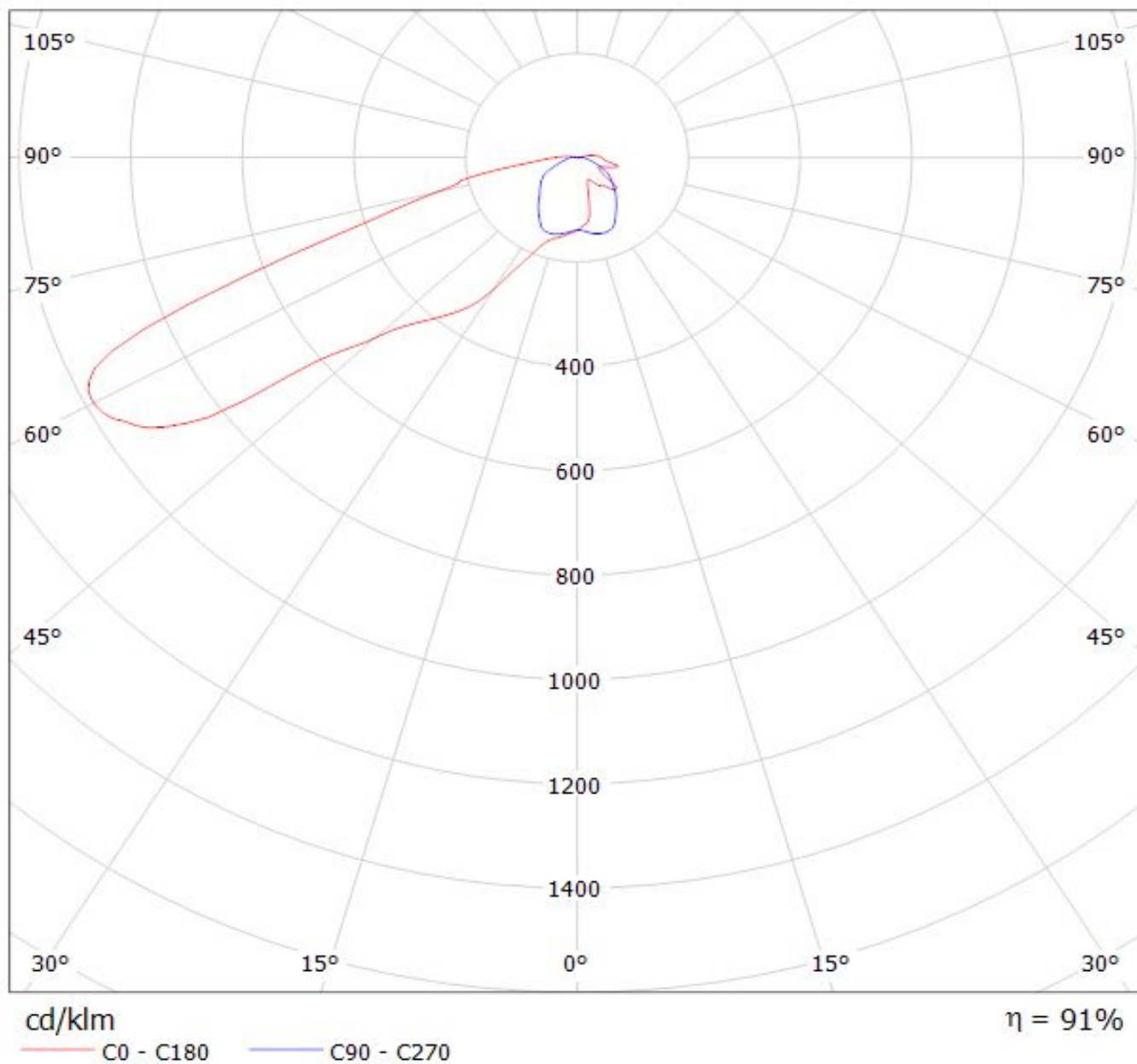

Luminaire: LEDiL Oy CA15226_STRADA-SQ-FS3_(PSL440)
Lamps: 1 x Citizen_PSL440_254.954lm@250mA_P=2.86296W_I=0.250A

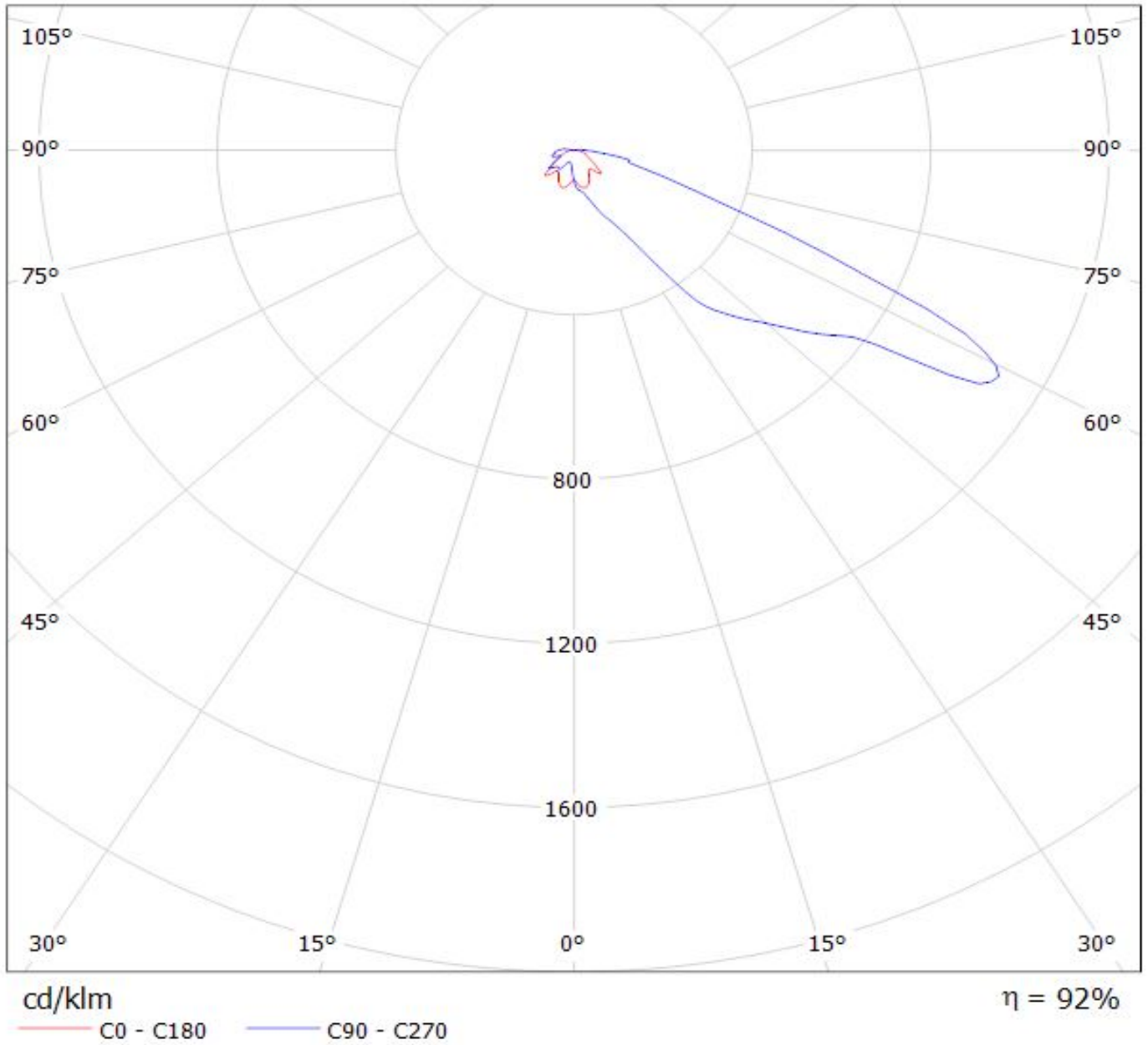

Luminaire: Ledil CA15226_STRADA-SQ-FS3_(MK-R)

Lamps: 1 x Cree_MK-R_(MKRAWT-0-30H-F2-D0-U-01)_300.489lm@250mA_P=2.8650W_I=0.250A

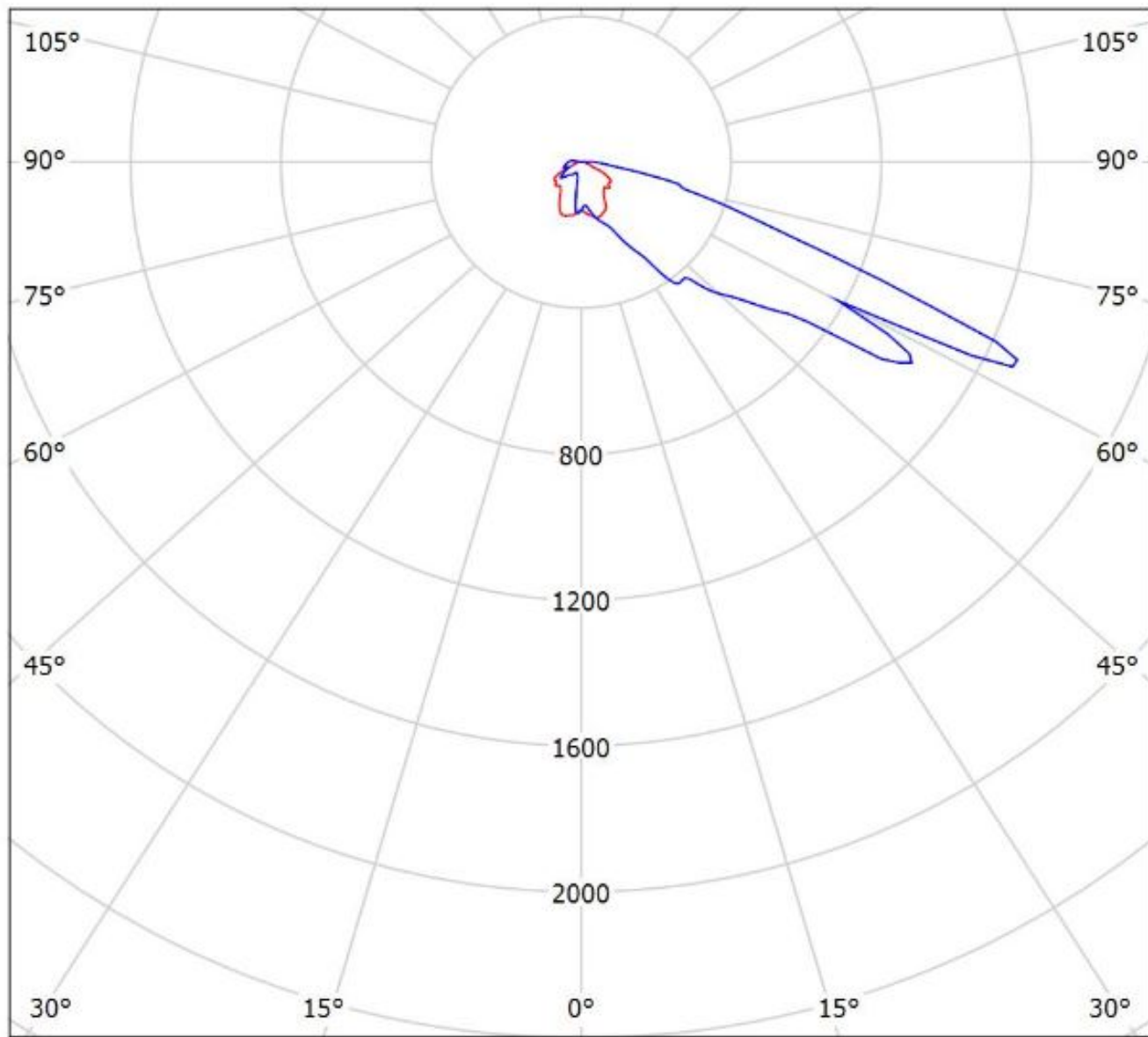

cd/klm

— C0 - C180

— C90 - C270

$\eta = 88\%$

Luminaire: Ledil Oy CA15226_STRADA-SQ-FS3_(XM-L2)_SIMULATED
Lamps: 1 x Cree XM-L2

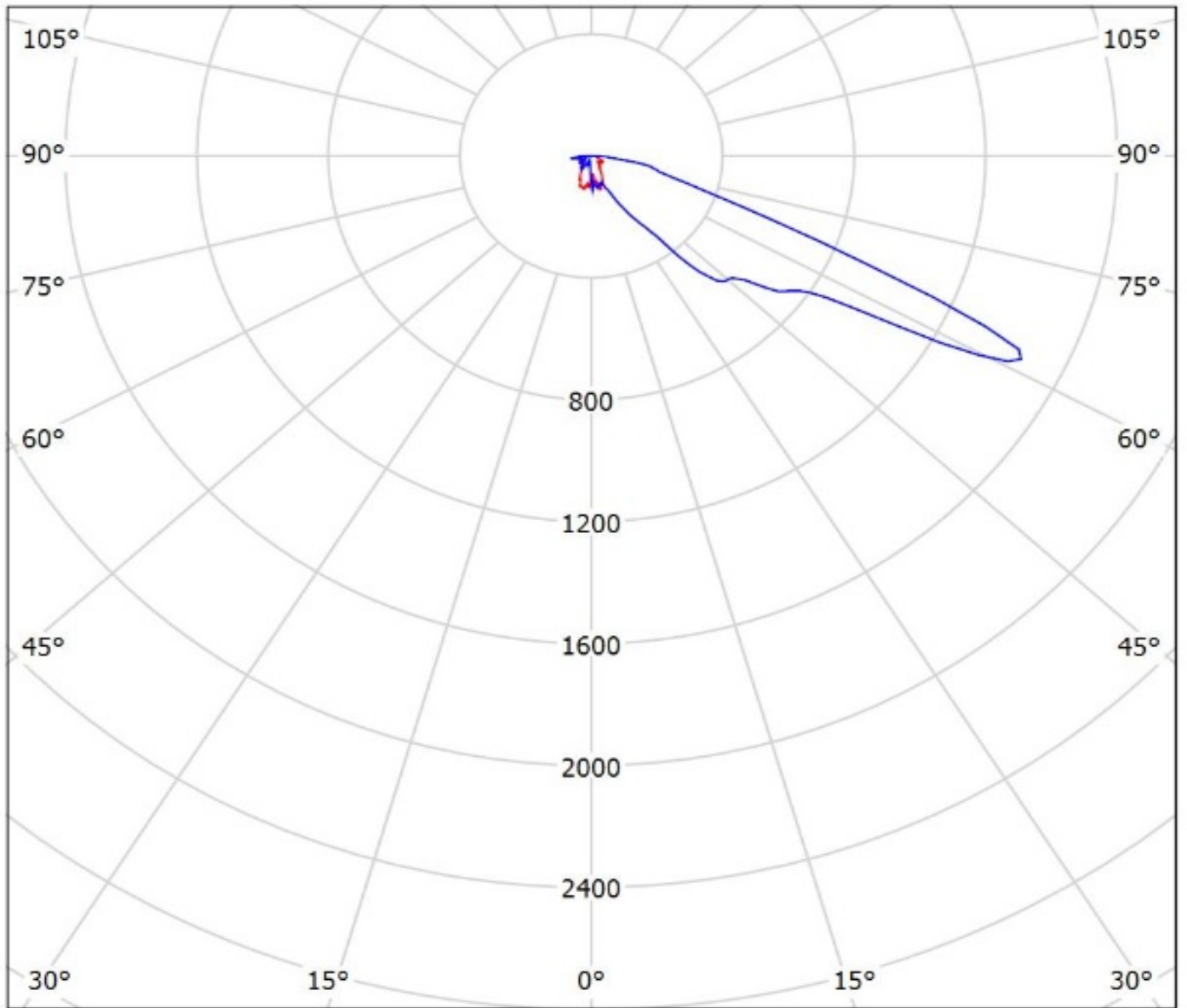

cd/klm
— C0 - C180 — C90 - C270

$\eta = 88\%$

Luminaire: Ledil Oy CA15226_STRADA-SQ-FS3_(XT-E)_SIMULATED

Lamps: 1 x Cree XT-E

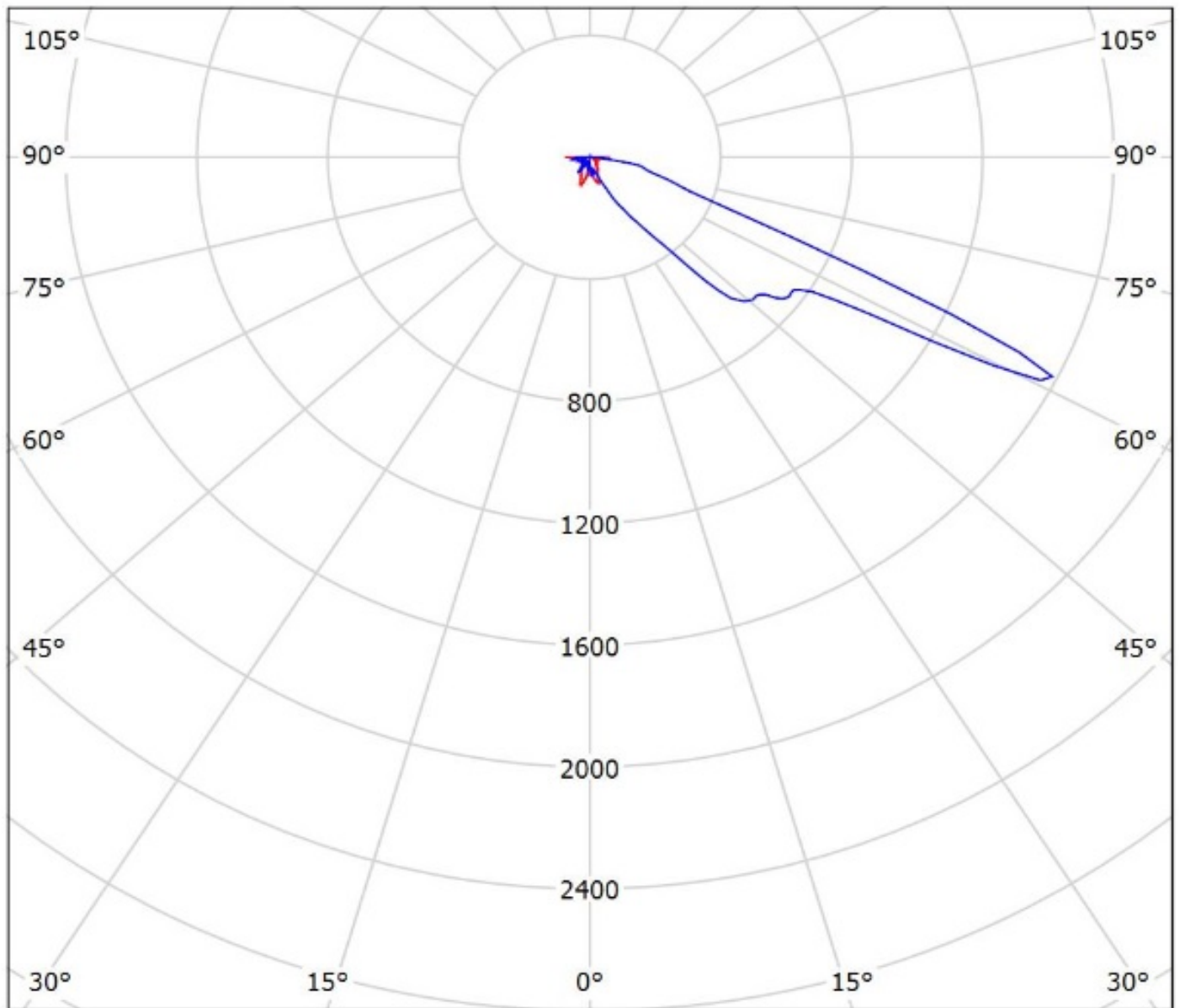

cd/klm

— C0 - C180 — C90 - C270

$\eta = 87\%$

Luminaire: LEDiL Oy CA15226_STRADA-SQ-FS3_(DURIS_S10)

Lamps: 1 x Osram_Duris_S10_(GW-P7LP32-EM)_966.113lm@250mA_P=9.19689W_I=0.250A

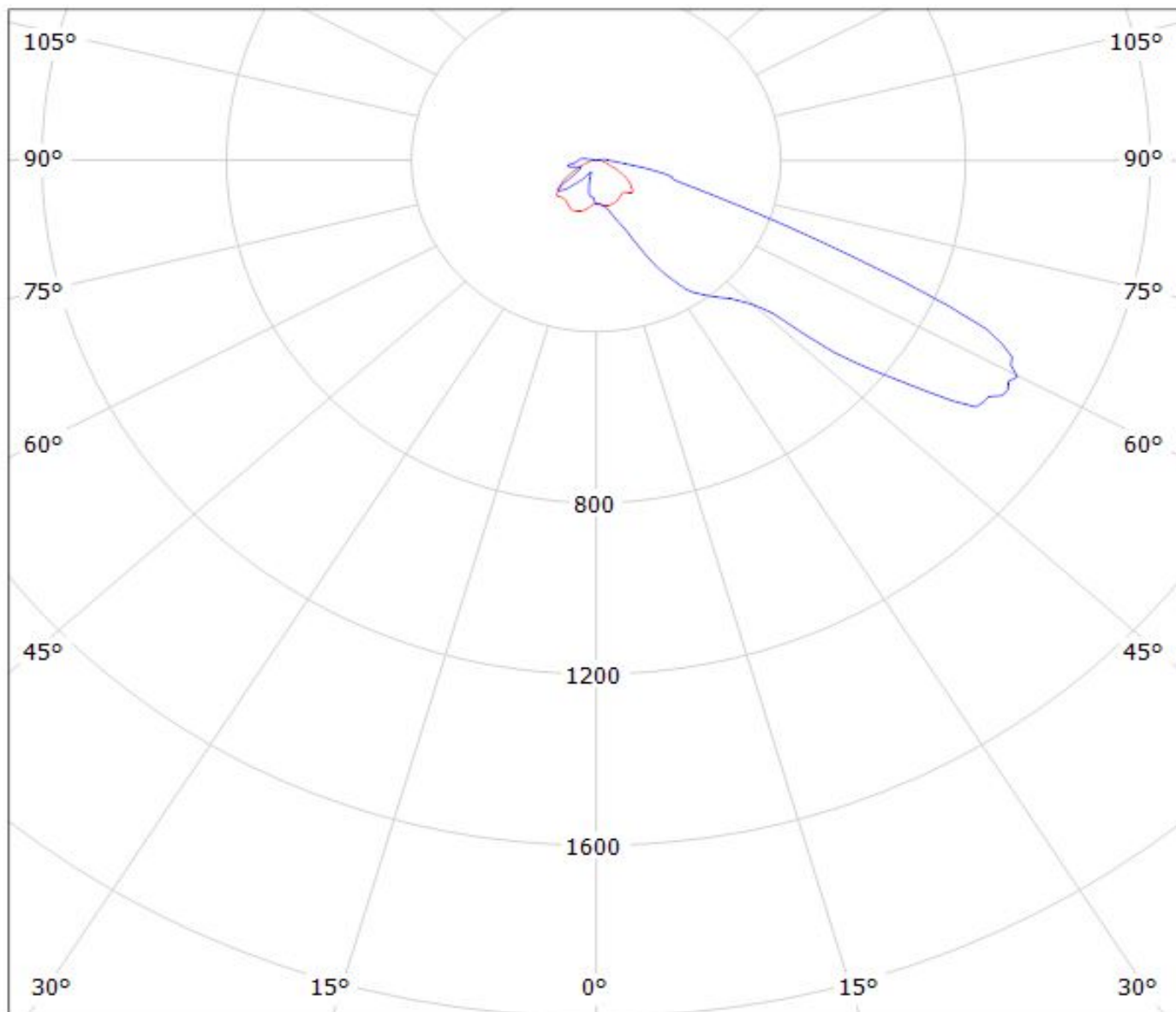

cd/klm

— C0 - C180

— C90 - C270

$\eta = 86\%$

NOTE: The typical divergence will be changed by different color, chip size and chip position tolerance. The typical total divergence is the full angle measured where the luminous intensity is half of the peak value.