

THIS DRAWING IS UNPUBLISHED. RELEASED FOR PUBLICATION 20
 © COPYRIGHT 20 BY TYCO ELECTRONICS CORPORATION. ALL RIGHTS RESERVED.

LOC	DIST	REVISIONS					
AF	50	P	LTR	DESCRIPTION	DATE	DWN	APVD
				C3 REVISED PER ECR-09-012939	16JUN2009	HMR	GP

SUGGESTED MATING TAB

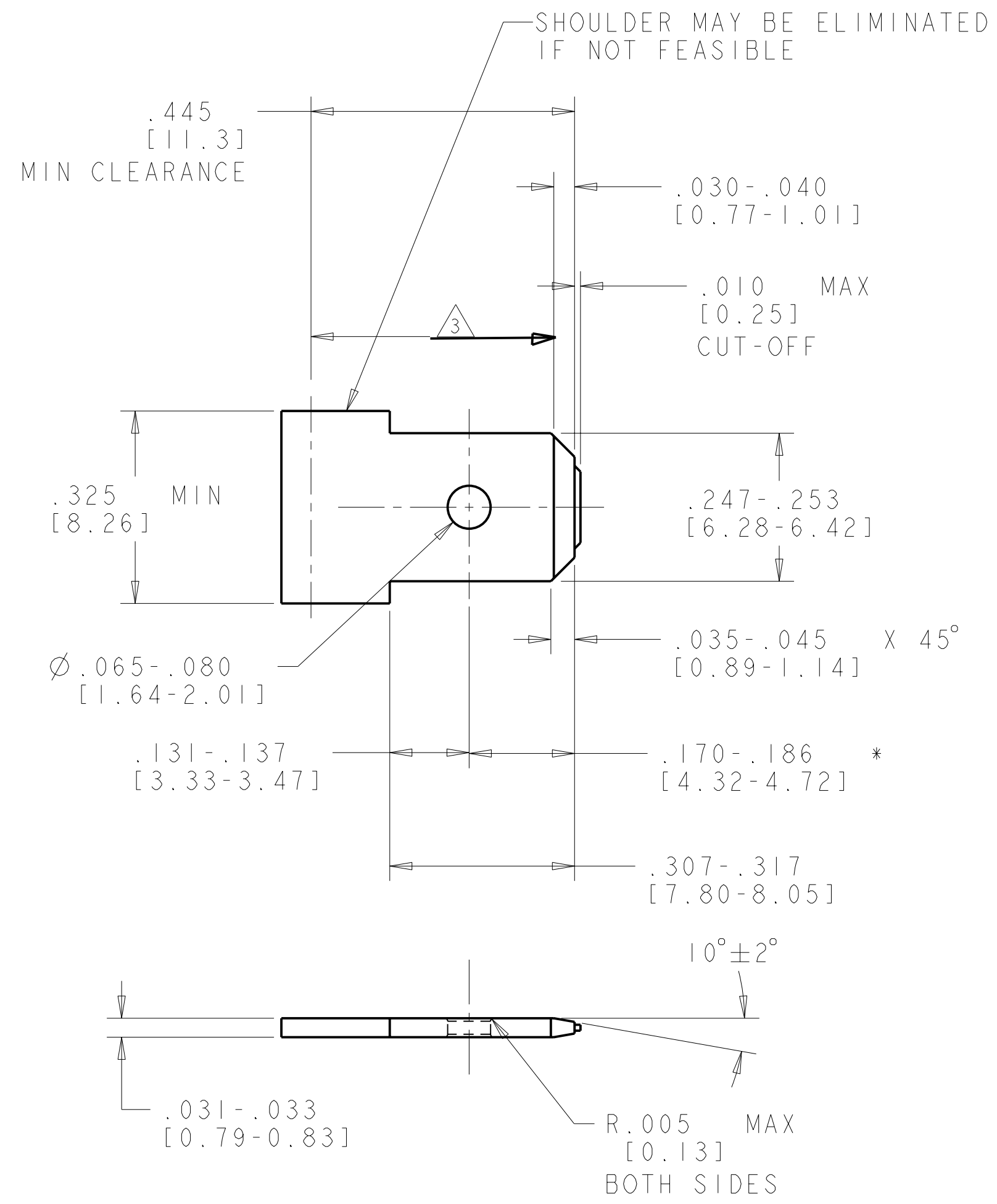

- 1. REPRESENTATIVE FASTON LIF RECEPTACLE INCLUDES 63306 SERIES. REPRESENTATIVE POSITIVE LOCK MKIII RECEPTACLES INCLUDES 63854 SERIES.

2. GLOW WIRE APPROVED MATERIAL, CONTACT TE ENGINEERING FOR SPECIFICATIONS.

5. MATERIAL: NYLON 66, UL94V-0, WITH UL HWI=0 AT .028[0.71] MINIMUM THICKNESS.

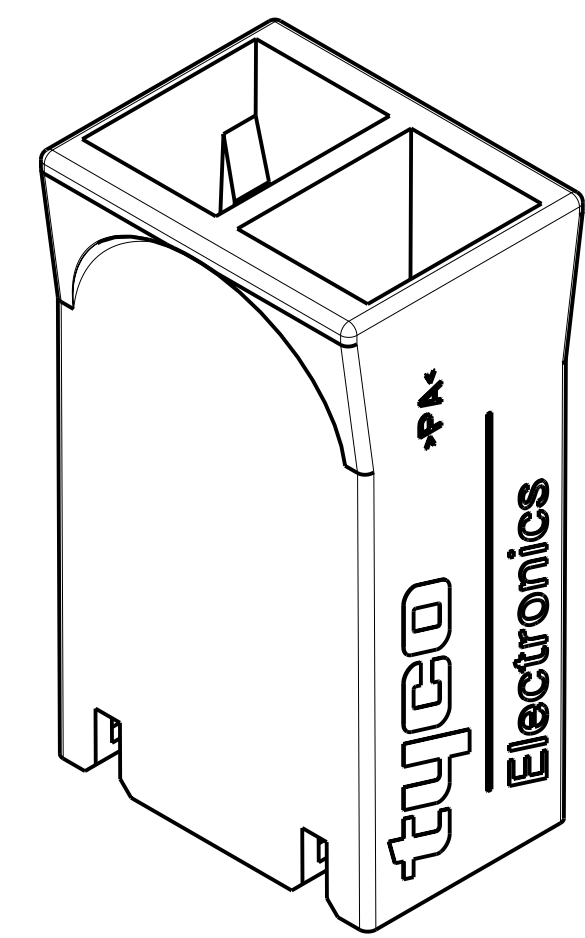
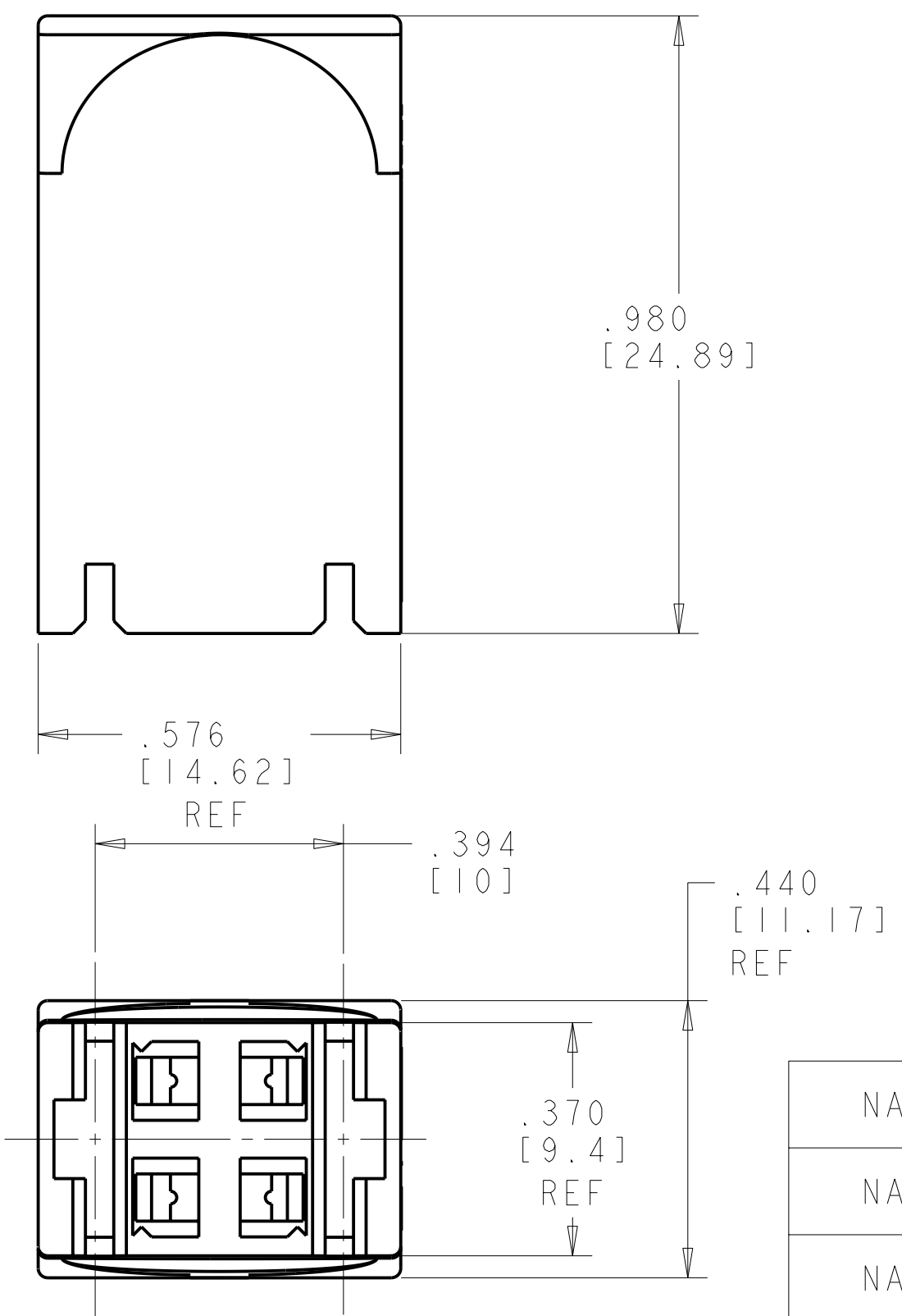

- 1 MATERIAL: 1/2 HARD BRASS OR NICKEL PLATED STEEL.
- 2 NO BURRS PERMISSIBLE AT HOLE.
- 3 MUST BE FLAT WITHIN .003 [0.076] OVER THIS LENGTH.
- 4 TIN PLATING IS REQUIRED ON BRASS WHEN TEMP. IS OVER 225°F.
- 5 HOLE MUST BE SYMMETRICAL ABOUT TAB CENTERLINE WITHIN .003 [0.076].

* TO BE USED ONLY WHEN SHOULDER IS ELIMINATED.

NATURAL	5	521766-3
NATURAL	NYLON 6, UL94V-2 2	521766-2
NATURAL	NYLON V0	521766-1
COLOR	MATERIAL	PART NUMBER

THIS DRAWING IS A CONTROLLED DOCUMENT FOR TYCO ELECTRONICS CORPORATION. IT IS SUBJECT TO CHANGE AND THE CONTROLLING ENGINEERING ORGANIZATION SHOULD BE CONTACTED FOR THE LATEST REVISION.

DWN	R FLAIG	04NOV2004	Tyco Electronics Harrisburg, PA 17105-3608			
CHK	K YI	04NOV2004				
APVD	K YI	04NOV2004				
NAME	HOUSING, RECEPTACLE, FASTON LIF, POSI-LOCK MKIII, .250 SERIES					
DIMENSIONS:	TOLERANCES UNLESS OTHERWISE SPECIFIED:		SIZE	CAGE CODE	DRAWING NO	RESTRICTED TO
INCHES	0 PLC ± 1 PLC ± 2 PLC ± 3 PLC ±.010 4 PLC ± ANGLES ±2° FINISH		A200779	C-521766		
MATERIAL			WEIGHT	CUSTOMER DRAWING		SCALE 4:1
			SHEET	OF	REV	C3